

Veterinarians

How to connect a GPR+ microchip scanner to the FEI HorseApp

You have a GPR+ microchip scanner?

You will use the FEI HorseApp at your next Event to perform the Examination on Arrival?

Below you will find the step-by-step procedure to connect your scanner to the FEI HorseApp

Step 1: Turn on the scanner and make sure the Bluetooth symbol in the top left corner of the screen is flashing.

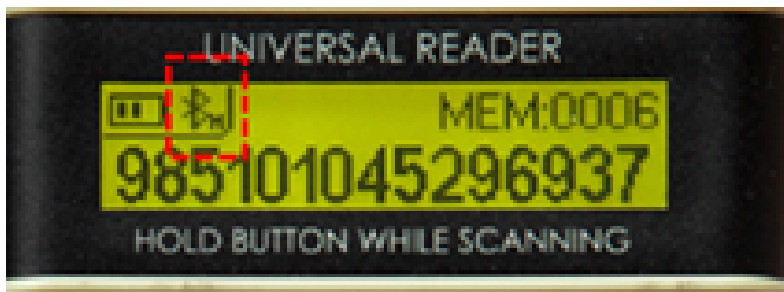

Please note: if the Bluetooth symbol is not flashing, it might mean that the GPR+ scanner is already connected to another device.

Step 2: On your mobile device, go to **Settings** -> **Bluetooth** and make sure the Bluetooth is ON on your device

iOS devices (iPhones & iPads):

Android devices:

Veterinarians

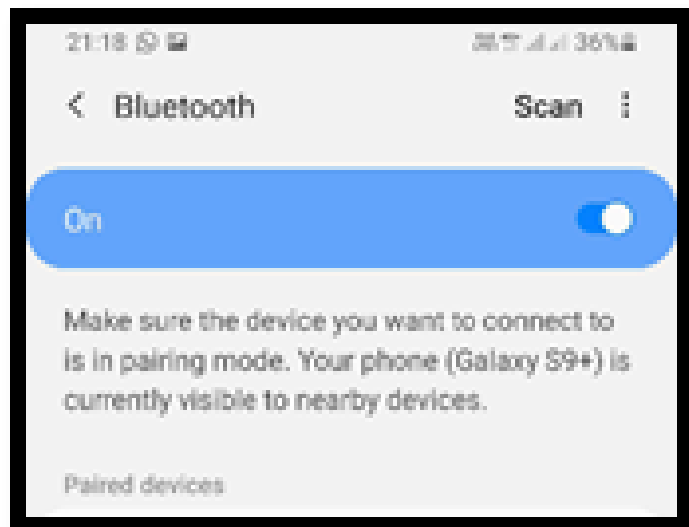
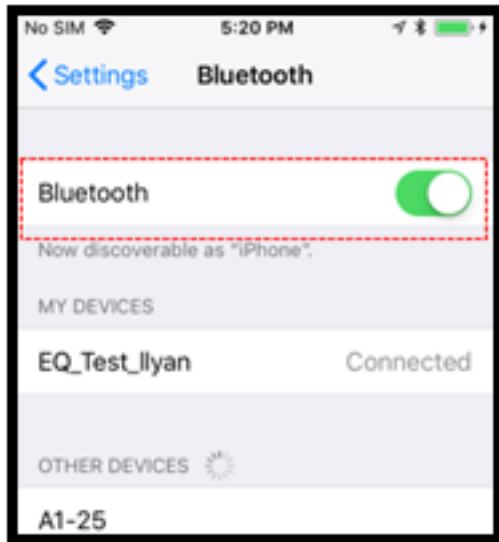

The mobile device will search for the microchip reader.

Step 3: Select the GPR+ scanner that appears in the list under the name GPR+*****.

The scanner is now paired with your device.



Step 4: Open the [FEI HorseApp](#) and login with your FEI credentials. Choose that you wish to **act as a Veterinarian**.

Click on **Not Connected** to connect the GPR+ scanner to the FEI HorseApp.

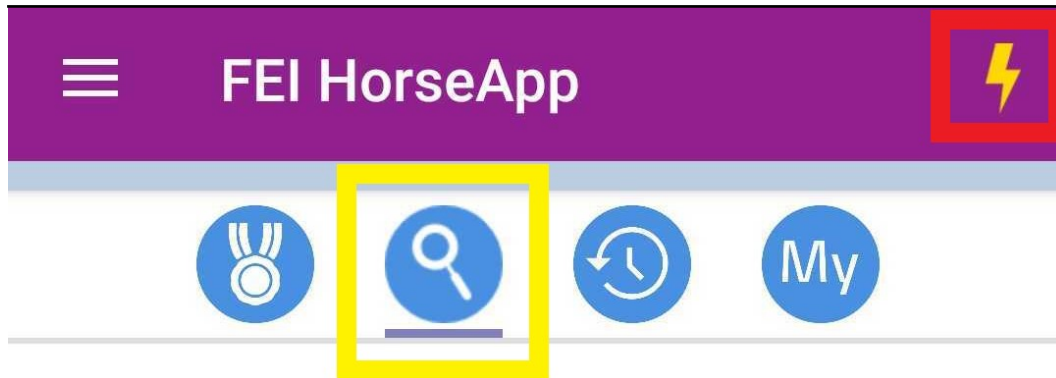
Veterinarians



Horse Search

-  **Advanced search**
Search for a horse by name or FEI ID >
-  **Scan barcode**
Scan a FEI document barcode >
-  **Scan microchip**
Scan with an external reader >

Not connected

Veterinarians

Step 5: Locate the GPR+ scanner in the list and click on Connect.

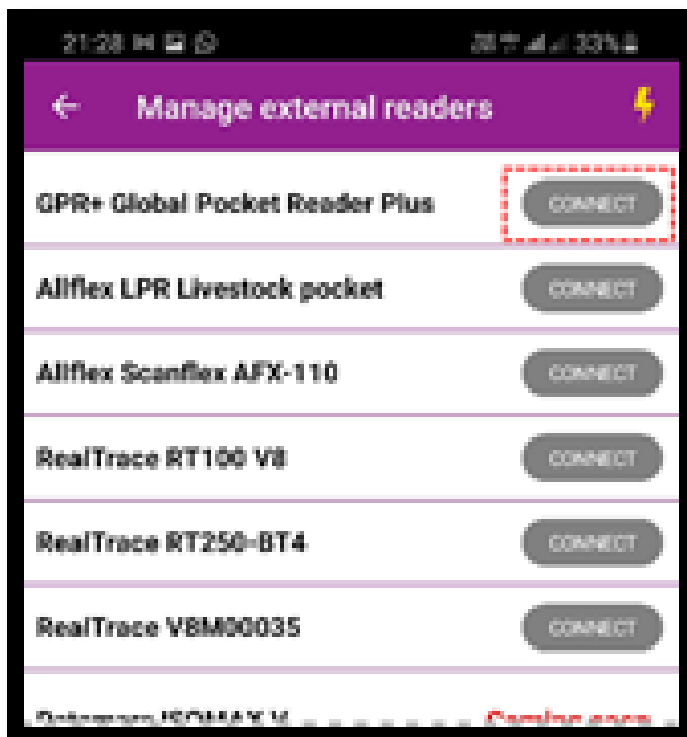

Please note: the first time you connect your GPR+ scanner it might take several minutes or attempts to connect it

Step 6: Once the GPR+ scanner is connected to the FEI HorseApp, the button will turn **green** and the **thunderbolt** logo will also show that you are correctly connected.

Veterinarians

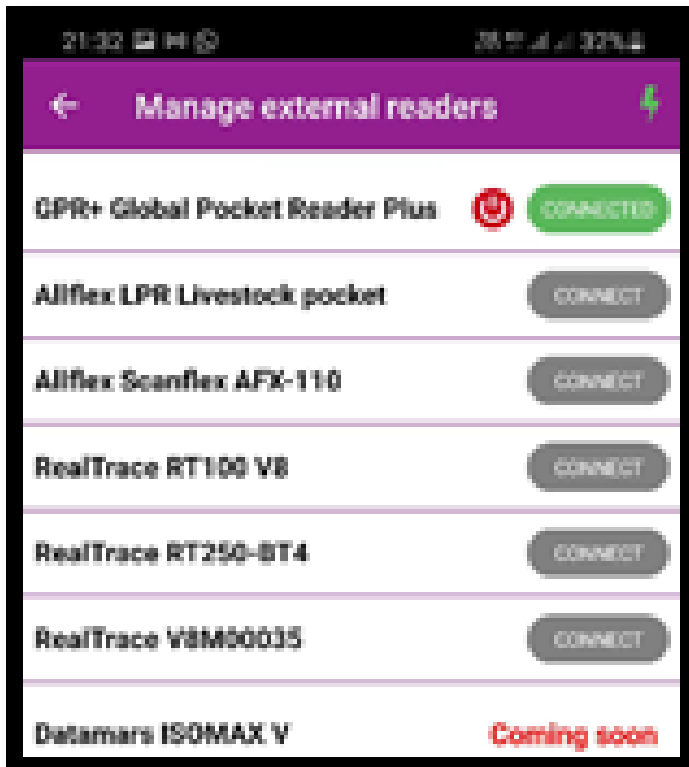



You can use this screen to disconnect your microchip scanner if you wish.

Step 7: You can now proceed with scanning a Horse. The scanner will work whenever it is **connected**.

To scan, search for the horse microchip and press the center button on the GPR+ scanner. The horse' profile will open on the FEI HorseApp accordingly.

Veterinarians



20:30   

< Veterinary Examination

HORSE DETAILS Entries Unlocked

'SME
981098106996605



GBR04916 Gelding 01/01/1982 (39y)

Owner: test (GBR)

Microchip: 981098106996605

ACTIONS

HORSE TEMPERATURE

 °C  °F

+ 3 7 . 7 +

- - -

Cancel Submit

[Click here to see how to use the FEI HorseApp during the Examination on Arrival](#)

Veterinarians

Unique solution ID: #1251

Author:

Last update: 2022-06-22 10:24