

# Horses

## How to use the FEI HorseApp to upload horse documents

You need to upload Horse's document to the FEI Database and you want to use the FEI HorseApp?

**Step 1:** Download the FEI HorseApp on your smartphone or tablet. The application is available on both iOS and Android Devices.

[Click here for all information related to the FEI HorseApp including the links to download the App.](#)

**Step 2:** To see how to use the FEI HorseApp to upload horse documents, please consult the step-by-step guidelines below or watch the following video:

To note: click on 'Watch on YouTube' to open the video in full screen.

Click [here](#) to see which pages of the horse's identification document need to be uploaded on the FEI Database.

### **Step-by-step process to upload photos of Horse documents on the FEI HorseApp:**

**Step 1:** Log in to the FEI HorseApp with your FEI ID number and password.

[Click here](#) to see how to log in to the FEI HorseApp.

**Step 2:** Navigate to the search section to find the Horse. You can search for a Horse by its FEI ID number or name.

# Horses

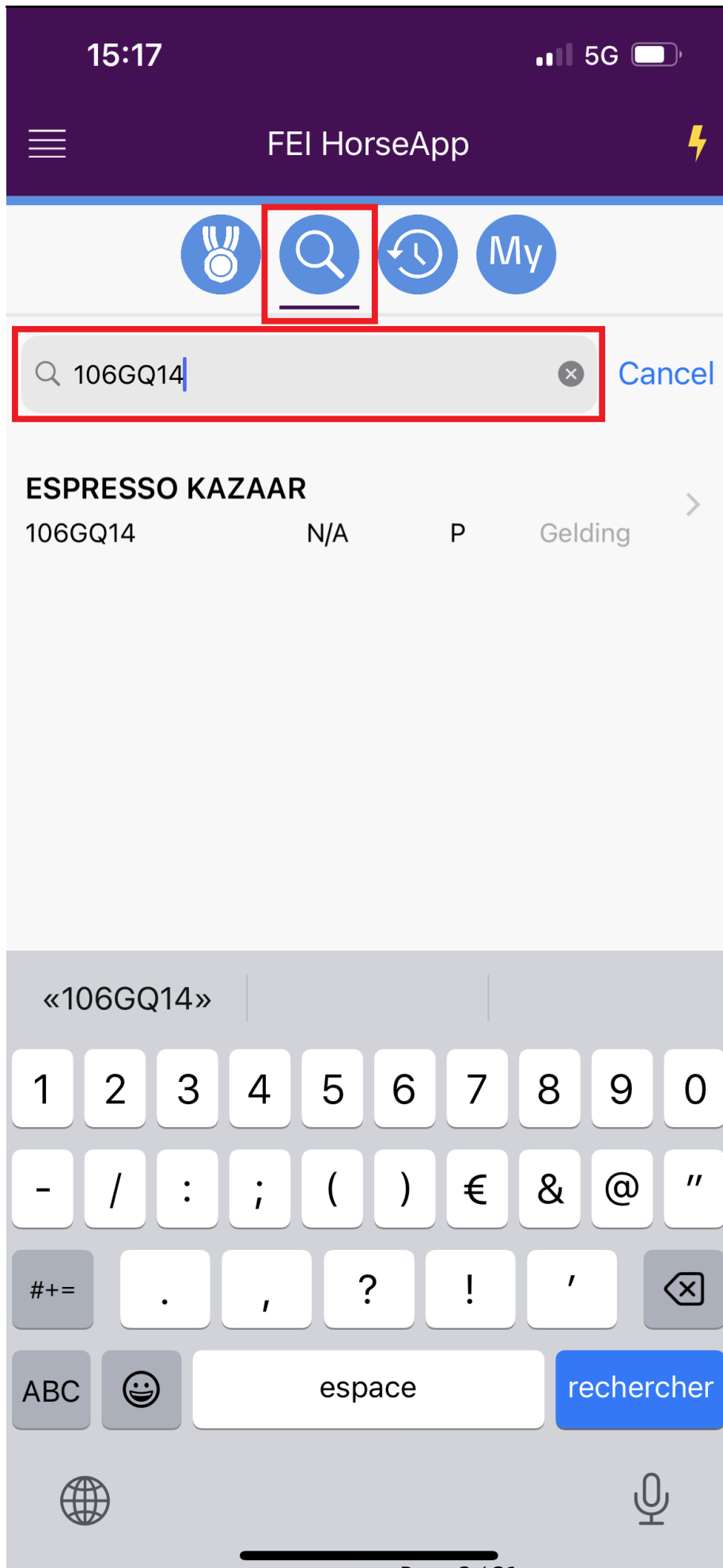

# Horses

**Step 3:** You will land on the Horse's page. Click on **Horse Documents**.

# Horses

15:17

5G



Horse details



**ESPRESSO KAZAAR**



106GQ14

3 EHV-1 requirements violation(s)

Expand

You are associated with this horse



Persons Associated



Horse Health



Horse Movement



Horse Pictures



Horse Documents

# Horses

**Step 3:** You will be able to see which document is require to have pages uploaded.

# Horses

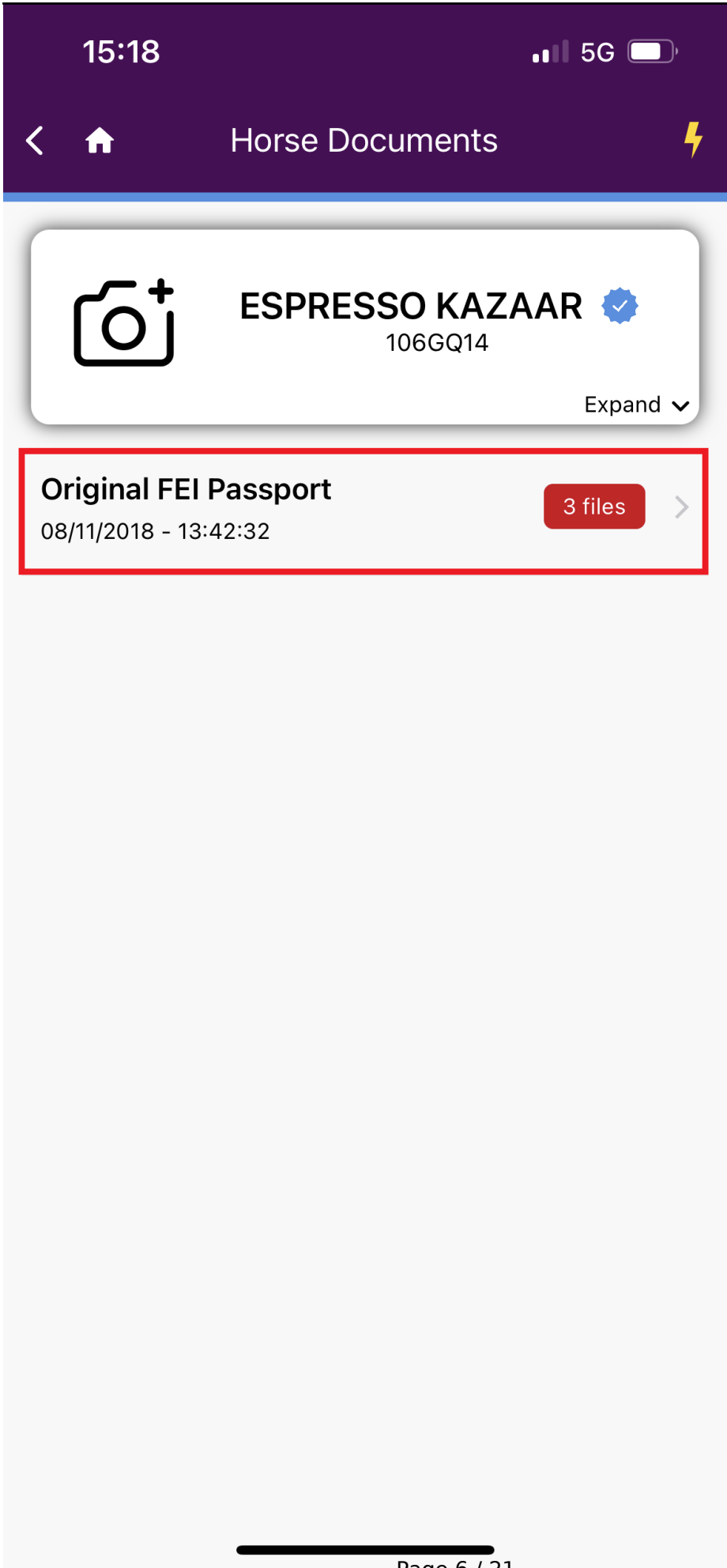

# Horses

**Step 4:** Select the page you wish to upload.

# Horses

15:19

5G



Horse Documents



ESPRESSO KAZAAR



106GQ14

Expand

DOCUMENTS

2 / 4



Description and  
Diagram Page

08/11/2018 - 14:46:44

Validated



Name Page

Press to add file

Required



Name Page Nat. Doc

Press to add file

Optional



Owner Page

08/11/2018 - 14:45:39

Validated



Pedigree Page

Press to add file

Required



Add a page

Press to add file

Optional





# Horses

You can choose to take a photo or choose a photo from your library.

**Step 5:** Make sure the page is not cropped and that all information is visible and in a good quality.

# Horses



## PASSPORT FOR HORSES PASSEPORT POUR CHEVAUX PASAPORTE PARA CABALLOS

ESPRESSO KAZAAR

**106GQ14**

FEI recognized document no.

FEI Sticker  
Issuing Body  
Authorized by FEI

1

Original horse name

ESPRESSO KAZAAR

UEN

Microchip no.

82609720007711

Valid

08/11/2022



Revalidation every 4 Years

A revalider tous les 4 ans

Revalidado cada 4 años

Revalidation every 4 Years

A revalider tous les 4 ans

Revalidado cada 4 años

Revalidation every 4 Years

A revalider tous les 4 ans

Revalidado cada 4 años

.5

1x

3

1

PHOTO

Cancel

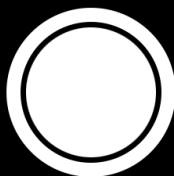

# Horses

**Step 6:** Confirm the page of the Horse's document you are uploading.

# Horses

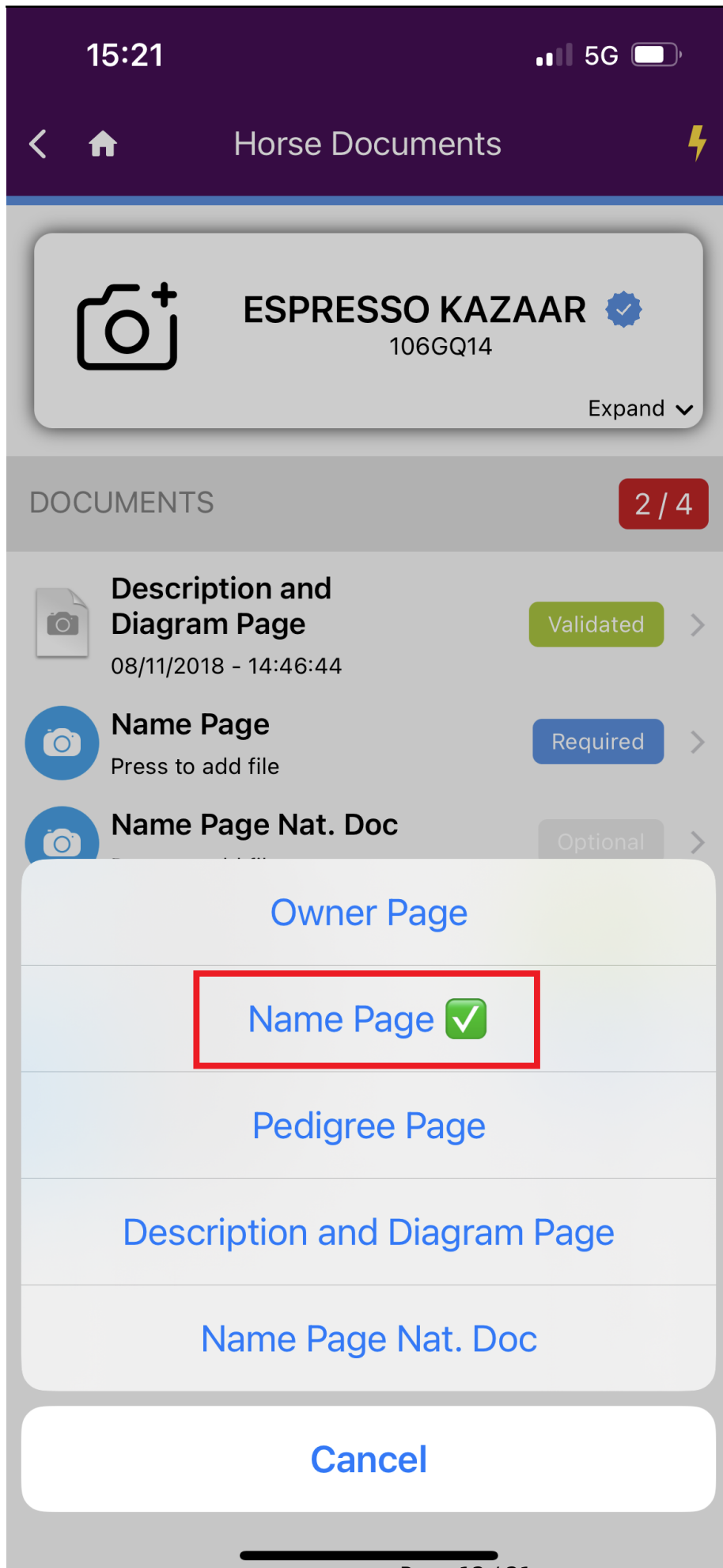

# Horses

**Step 7:** You will see the status **Uploaded** for the page you have uploaded.

Once the document is verified and validated by the FEI, you will see the status **Validated**.

# Horses

15:21

5G



Horse Documents



ESPRESSO KAZAAR



106GQ14

Expand

DOCUMENTS

3 / 4



Description and  
Diagram Page

08/11/2018 - 14:46:44

Validated



Name Page

19/12/2022 - 14:21:28

Uploaded



Name Page Nat. Doc

Press to add file

Optional



Owner Page

08/11/2018 - 14:45:39

Validated



Pedigree Page

Press to add file

Required



Add a page

Press to add file

Optional



# Horses

You can open the page only of the document(s) you have uploaded. If the page has been uploaded by another person, you will not be able to see the horse document.

**Step 8:** If a document is refused by the FEI, click on **Refused** to see the reason why the page has been refused.

# Horses

15:24

5G



Horse Documents



ESPRESSO KAZAAR



106GQ14

Expand

DOCUMENTS

3 / 4



Description and  
Diagram Page

08/11/2018 - 14:46:44

Validated



Name Page

19/12/2022 - 14:21:28

Validated



Name Page Nat. Doc

Press to add file

Optional



Owner Page

08/11/2018 - 14:45:39

Validated



Pedigree Page

Press to view file

Refused



Add a page

Press to add file

Optional





# Horses

**Step 9:** A pop-up window will open with the rejection comment.

# Horses

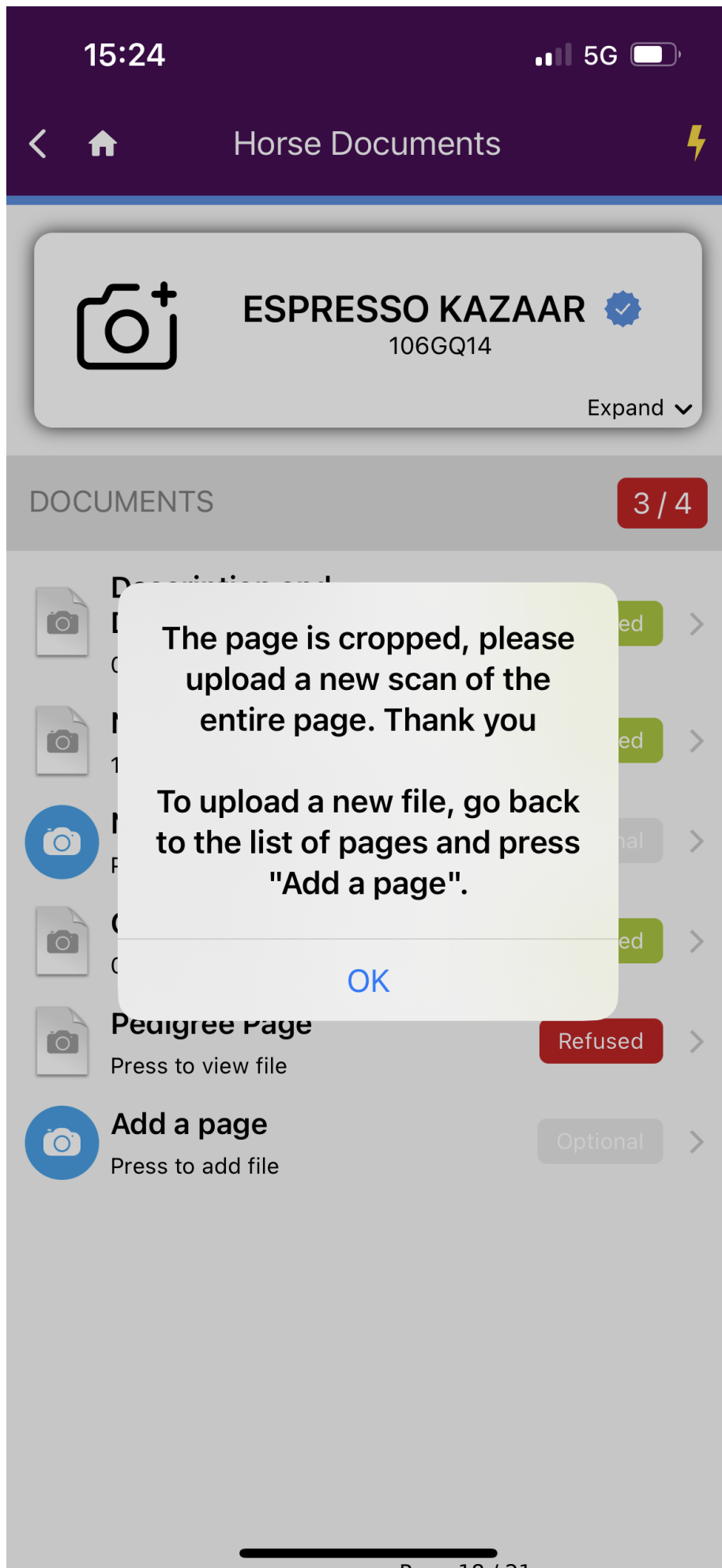

# Horses

**Step 10:** When all the required pages are uploaded and validated, this will be indicated in the top right corner in **green**.

# Horses

15:25

5G



Horse Documents



ESPRESSO KAZAAR



106GQ14

Expand

DOCUMENTS

4 / 4



Description and  
Diagram Page

08/11/2018 - 14:46:44

Validated



Name Page

19/12/2022 - 14:21:28

Validated



Name Page Nat. Doc

Press to add file

Optional



Owner Page

08/11/2018 - 14:45:39

Validated



Pedigree Page

19/12/2022 - 14:22:17

Validated



Add a page

Press to add file

Optional



# Horses

Please note:

- Only Athletes and National Federation members can upload Horse documents on the FEI HorseApp.
- Your National Federation can still make your entry on the FEI Entry System for a future FEI Event if the documents are not yet validated by the FEI.

If you have any questions or require any assistance, please contact [usersupport@fei.org](mailto:usersupport@fei.org)

Unique solution ID: #1066

Author:

Last update: 2023-03-14 15:39