

General Questions

How to consult the status of my entries on the FEI SportApp

You are an FEI athlete and you want to know if your entry for a show has been accepted?

You have logged into the FEI SportApp and wish to view your entry status?

If you need to download the FEI SportApp, please see "[How to use the FEI SportApp](#)".

My Entry Status

You are logged in and have clicked on the "**ME**" in the menu bar.

You can then select "**My Entries**" in the drop down list.

Here you can see all upcoming entries made by your National Federation.

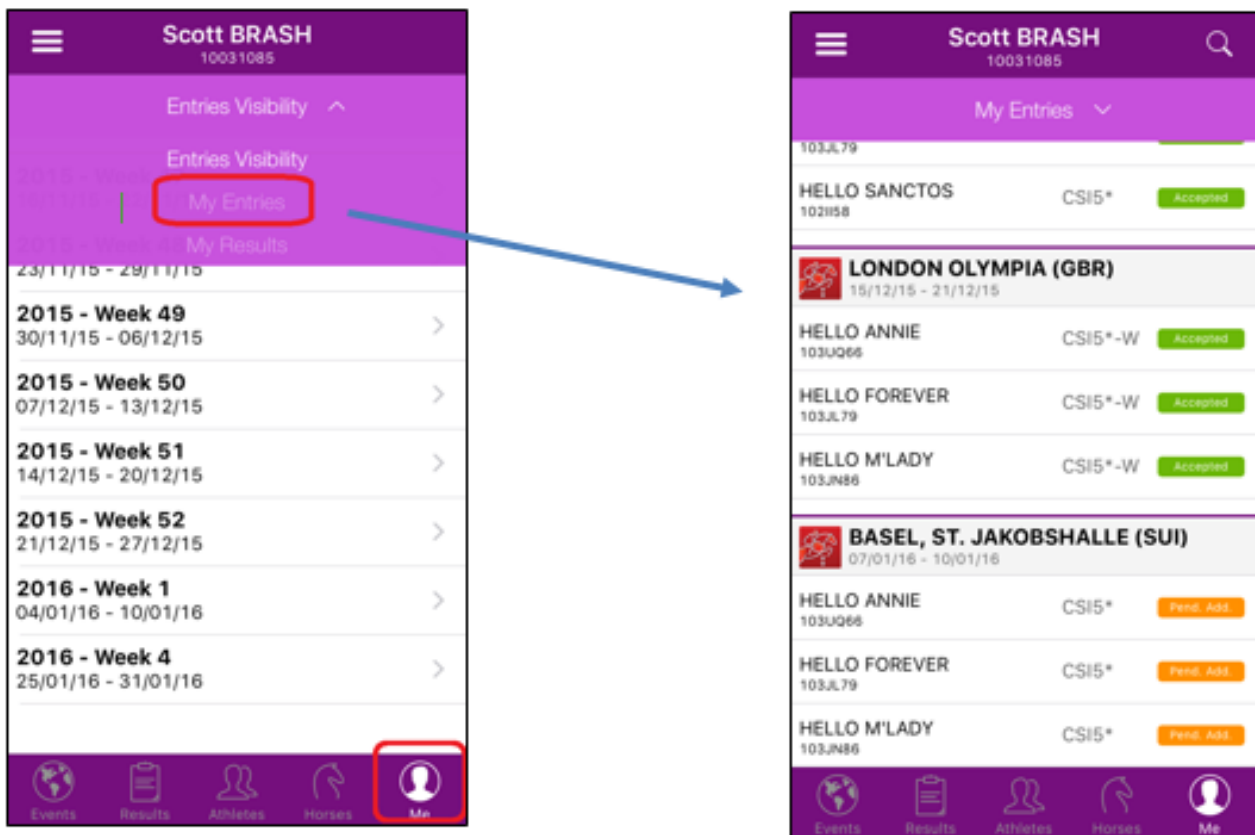

General Questions

Green – Accepted: The entry has been accepted by the Organising Committee
Black – Withdrawn: The entry has been withdrawn by the National Federation
Orange – Waiting for OC: The entry has been made by the NF; the OC needs to accept

If there is an entry missing or a problem with your entry status, please contact your National Federation.

["How to contact my National Federation."](#)

Share your entries status / invitations

By clicking on **"Invitations"** you have the possibility to share your profile /entries, with your Team Manager, Groom, Owner etc.

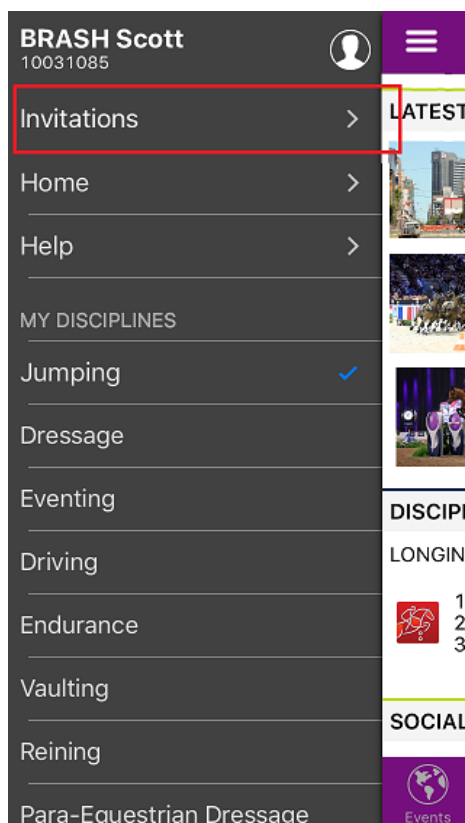

General Questions

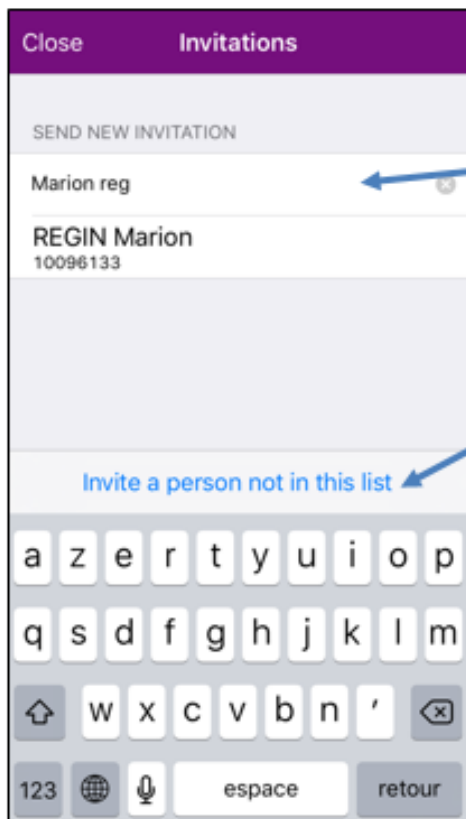

Type the name / FEI ID number if the person has a profile in our database

If not, click here and fill in the form



Select a category for the profile

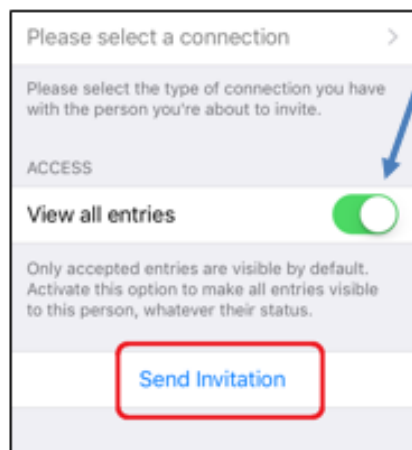
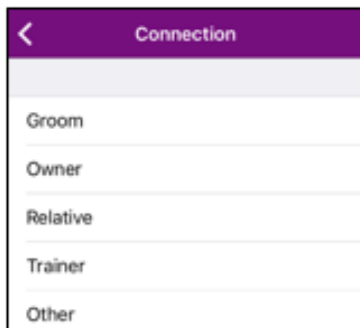

General Questions

Unique solution ID: #1019

Author: Marion Régin

Last update: 2018-03-24 19:59